

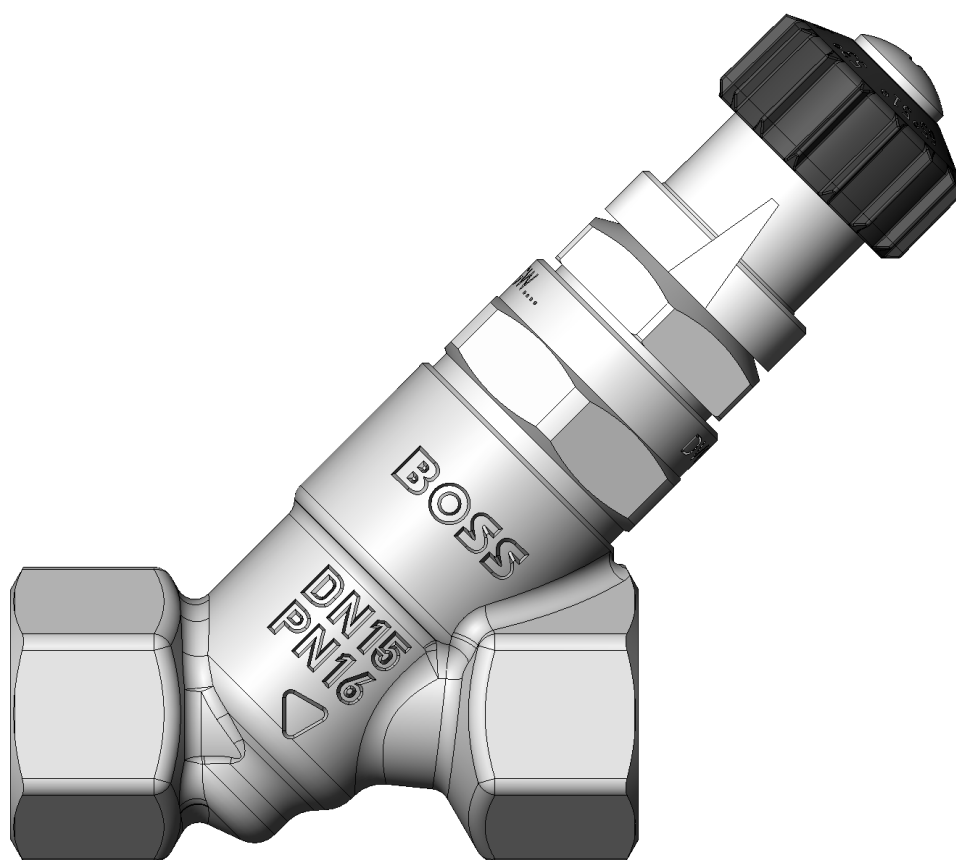

# Installation and Operating Instructions

## BOSS™ 205 TBV (50°C – 65°C), DN 15 – DN 20



### INDEX

1. Preface .....	2
2. Application .....	2
3. Technical Data .....	2
4. Installation information .....	2
5. Adjustment of set-point temperature .....	3
6. Thermal disinfection .....	3



## 1. Preface

This manual is guidance for installation and operation of the BOSS™ 205 TBV. This manual has to be read before starting the installation. This valve must be installed according to the relevant guides and standards. The manufacturer is not liable for any damage that is caused by wrong installation or handling.

## 2. Application

The BOSSTM 205 TBV is for hydraulic balancing of domestic hot water systems. It maintains set temperatures in the hot water installation and supports thermal disinfection.

## 3. Technical Data

Operating range	50°C – 65°C
Factory pre-setting	58°C
Temperature range for thermal disinfection	≥ 70°C
Max. operating temperature	90°C
Accuracy	+/- 2°C
Nominal pressure	PN 16
Nominal sizes	DN 15, DN 20
Type	BOSS™ 205 TBV

## 4. Installation information

Incorrect size selection and / or temperature setting of the valve could cause danger of pollution and Legionella in the plumbing installation.

The BOSS™ 205 TBV must be installed in correct flow direction. The flow direction is indicated by an arrow on the body of the valve. It can be installed in any orientation.

The valve has EN10226 BSPT threads.

To avoid malfunction, avoid dirt or debris entering the valve.

Install valves using a 27mm (for DN15) or 32mm (for DN20) spanner.

To prevent imposing strain on the valve joints, pipe work and valves must be adequately supported.



## 5. Adjustment of set-point temperature

The factory setting of the valve is 58°C.

If the pre-setting needs to be changed:

- Loosen the M5 screw with an allen key (size: 2.5)
- Turn the black cap until the desired setting is indicated above the white arrow.
- Fix the position by tightening the M5 screw carefully with an allen key (size: 2.5).

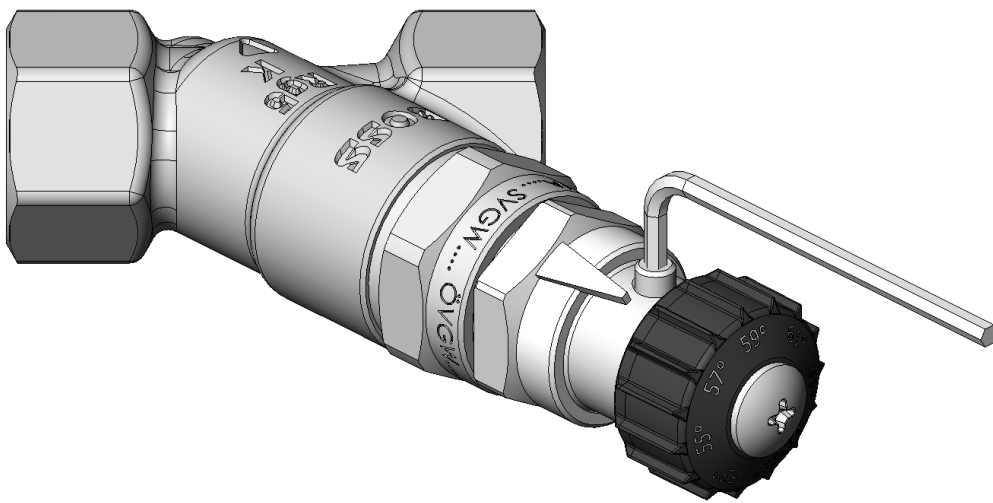

## 6. Thermal disinfection

The valve is suitable for thermal disinfection at temperatures greater than 70°C.

When the temperature rises to greater than 70°C, the valve automatically reaches the thermal disinfection regulating range.

If the temperature drops below 70°C again, it is back in normal operation.

**Registered Office: BSS Industrial Ltd.**

**Lodge Way House, Lodge Way, Harlestone Road, Northampton NN5 7UG United Kingdom**

**T: 0116 262 3232**

**F: 0116 253 1343**

**E: [enquiries@bssgroup.com](mailto:enquiries@bssgroup.com)**

**W: [www.bssindustrial.co.uk](http://www.bssindustrial.co.uk)**

**Date:**

**Issue:**

**Leaflet Code:**

**31<sup>st</sup> October 2014**

**1**

**BOSS20510/14**