



BOSS™ 38CMWF/38HMWF

Woltmann Water Meter

Data Sheet

General Description

BOSS Woltmann water meters come with a pulsed output as standard, flanged PN16 connections are available in sizes from 50mm to 200mm.



Features and Benefits

- Woltmann Helix design
- WRAS approved
- MID approved for horizontal and vertical installation
- Pulsed output as standard*
- 360° rotating dial
- Quiet operation

* MBUS output models also available upon request

Standard Features

- For cold water (up to 30°C) and hot water (up to 90°C)
- Ductile Iron body, Epoxy powder coated
- Working Pressure: up to 16 Bar
- Dry Dial
- 5 black rollers (cubic metres)
- BS 4505 PN16 flanged

Technical Data

BOSS™ 38CMWF BSS Code	BOSS™ 38HMWF BSS Code	DN Size	Min Flow	Trans Flow	Nom Flow	Max Flow	Starting Flow	Pulse Value
(Cold 30°C)	(Hot 90°C)	mm	m ³ /h	m ³ /h	m ³ /h	m ³ /h	m ³ /h	litres
38400494	38400653	50	0.6	1.5	15	30	0.15	100
38400502	38400664	65	0.8	2	25	60	0.2	100
38400513	38400675	80	1.4	3.2	45	90	0.25	100
38400524	38400686	100	1.8	4.8	70	140	0.25	100
38400535	38400697	125	3.5	8	100	200	0.5	100
38400546	38400705	150	5.5	12	150	300	1	1000
38400557	38400716	200	10	20	200	500	1.5	1000

*MID = H R100 / R80

Pressure Loss

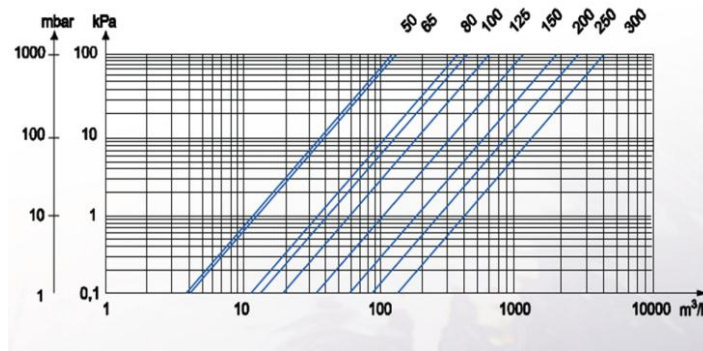

Dimensions

BOSS™ 38CMWF BSS Code	BOSS™ 38HMWF BSS Code	DN Size	Length (L)	Height (H)	Width (W)	Weight
(Cold 30°C)	(Hot 90°C)	mm	mm	mm	mm	kg
38400494	38400653	50	200	235	165	9.9
38400502	38400664	65	200	235	185	10.6
38400513	38400675	80	225	255	200	13.3
38400524	37400686	100	250	265	220	15.6
38400535	38400697	125	250	265	250	18.1
38400546	38400705	150	300	325	289	40.1
38400557	38400716	200	350	352	340	51.1

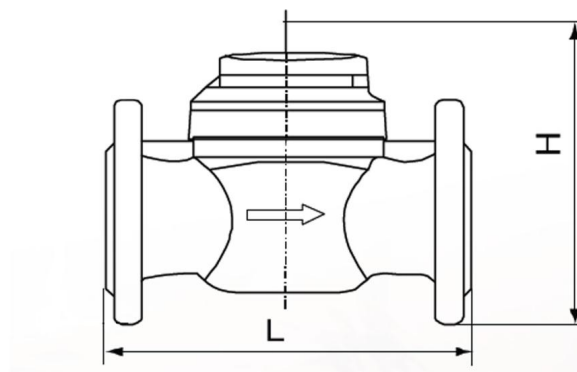

Terms of Reference

- **DN Size (mm)** – Refers to the inside bore diameter.
- **Minimum Flow Rate (l/h)** – The absolute minimum flow required for the unit to function.
- **Maximum Flow Rate (m³/h)** – Refers to the emergency flow rate in the event of system failure. Damage may result.
- **Transitional Flow Rate (l/h)** – Point at which the flow rate is high enough to achieve an accurate level of measurement.
- **Nominal Flow Rate (m³/h)** – Typical application for everyday usage.
- **Starting Flow Rate (l/h)** – The required flow velocity to enable the meter to register flow.
- **Pulse Value** – The volume of water required to pass through the meter to generate a pulse.

All sizes are approximate and are given for guidance only.

Products and specifications may be subject to change from those shown without notice.