

MODEL

BOSS 31 - 110 Volt

Code: 80630032

BOSS 31 - 230 Volt

Code: 80630043

SUBMERSIBLE PUMPS FOR DRAINAGE APPLICATIONS

HEAD
UP TO
6.3MTS

FLOW
UP TO
2.5 L/S

FLOAT
AUTO
YES

SUPPLY
VOLTS
1 PH

All BOSS products are supplied with the confidence of high quality and reliability as standard.

- Full service & technical back up



DURABILITY



Full stainless steel
construction materials

OPERATION



Automatic float switch
control

CAPABILITY



Solids handling up
to 10 mm

INSTALLATION



Fitted with 10 Metres
of mains cable

BOSS 31

TECHNICAL SPECIFICATION



HEAD UP TO	6.3 METRES
FLOW UP TO	2.5 L/SEC
CLOSED VALVE	7 METRES
MIN SUMP DIMENSION MM	H374 x W400x D400
OUTLET SIZE	1 1/4" F BSP
IMMERSION DEPTH MAX	10 METRES
MIN WATER LEVEL	65 MM (auto)
SOLIDS HANDLING	10 MM
MAX LIQUID TEMP	50°C
MOTOR SIZE	0.25 KW
MAINS SUPPLY	110 or 230 VOLT
RUNNING CURRENT AMPS	110 V- 5 230 V- 1.8
FLOAT SWITCH	YES
SUPPLY CABLE	10 METRES

APPLICATIONS

Multi purpose submersible electric drainage pump manufactured in stainless steel material. Designed for pumping clean and waste water containing solids in suspension up to a maximum of 10mm in diameter. Ideal for cellar drainage, pumping out flooded areas and water gardening applications.

CONSTRUCTION FEATURES OF THE PUMP

Pump body and impeller made completely in stainless steel, motor casing and shaft made in stainless steel.

Motor shaft mechanical seal arrangement.

CONSTRUCTION FEATURES OF THE MOTOR

Dry asynchronous sealed motor type cooled by the pumped liquid. Rotor mounted on greased for-life bearings, oversized and selected to guarantee greater noise reduction and durability.

Thermal overload motor protection as standard, auto-resetting.

Constructed in accordance with the IEC 2-3 IEC61-69 (EN 60335-2-41) standards.

Motor Protection Class: IP68

Insulation Class: F

Standard Voltage: 110 Volt and 230 Volt Single-Phase 50 Hz Options

Motor Rating: Continuous running with liquid at 35 °C max and pump completely submerged

MATERIALS

NO.	PARTS IN CONTACT WITH THE PUMPED LIQUID	MATERIALS
1	PUMP BODY	STAINLESS STEEL AISI 304
3	SUPPORT	STAINLESS STEEL AISI 304
4	IMPELLER	STAINLESS STEEL AISI 304
7	MOTOR SHAFT	STAINLESS STEEL AISI 416
16	MECHANICAL SEAL	SILICON CARBIDE/ALLUMINA
28	O RING	NBR
42	FILTER GRID	STAINLESS STEEL AISI 304
54	MOTOR CASING	STAINLESS STEEL AISI 304
69	PUMP LINER	STAINLESS STEEL AISI 304
77	PROTECTION COVER	TECHNOPOLYMER
	MAIN CABLE & FLOAT CABLE	H07 RN-F (PCP TYPE EM2)

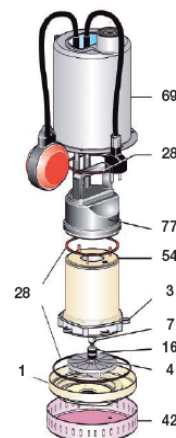

DIMENSIONS

MODEL (mm)	B	C	D	E	F	G	DIA DNM	WEIGHT KG
BOSS 31	154	43	234	214	35	132	1 1/4" F BSP	5.5

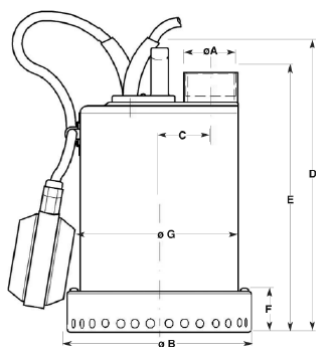

PERFORMANCE

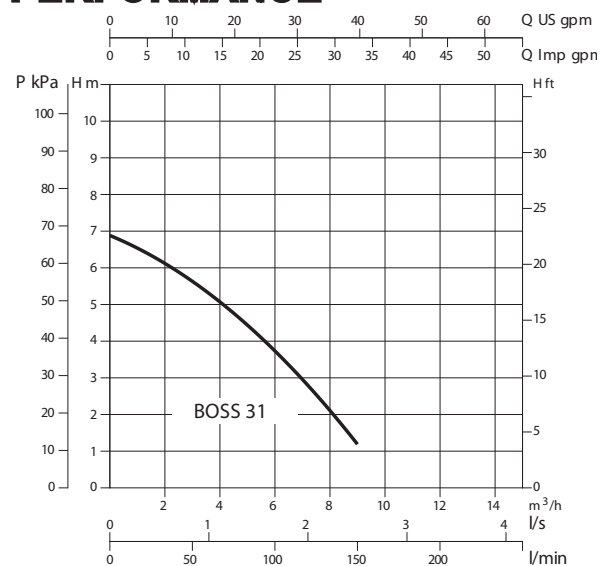

AMS Pumps

BSS | Specialist in Pumping Systems

Tel:

Email:

Web:

0870 609 2101

ampumps@bssgroup.com

www.bssindustrial.co.uk

The information contained in this publication is believed to be correct and complete at the time of printing but it is an approximate guide only. Due to limitations in the printing process, images may not be representative of their true colours and colour variations may occur due to the natural origin of the products. Stock may vary from branch to branch and is subject to availability. All photographs are a guide only and do not necessarily represent the products available. BSS Industrial reserves the right to change product details and designs without prior notice. To the fullest extent permitted by law, BSS Industrial assumes no liability or responsibility for typographical and clerical errors and omissions in this publication (which may be corrected by us without liability) and this publication does not form the basis of any contract. All products sold are subject to our Group Sale Terms, a copy of which are available on request or are otherwise available at www.bssindustrial.co.uk. Travis Perkins Group is the owner of the registered trademark BOSS.

Registered Office: Lodge Way House, Lodge Way, Harlestone Road, Northampton NN5 7UG