

Ball Valves

Full Bore – FIG LN240 2 pce 1000WOG

Dimensions

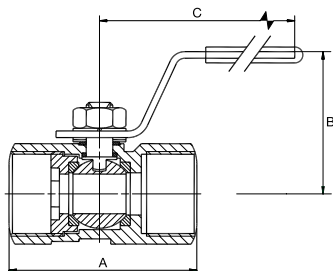

Stainless Steel Valve

Nominal Size	Bore Dia	A	B	C	Weight	Product Code
in	mm	mm	mm	mm	kg	
¼	8	11	51.5	53.3	0.264	36420001
⅜	10	12.5	51.5	53.3	0.25	36420012
½	15	15	63.2	58.5	0.378	36420023
¾	20	20	75.9	60.6	0.54	36420034
1	25	25.4	78.6	71.8	0.886	36420045
1¼	32	32	101.5	75.2	1.382	36420056
1½	40	38	108.6	92.5	2.2	36420067
2	50	50	122.5	101	3.34	36420078

Technical Specification

Connections	Screwed BSPT Female
Pressure/Temperature	10.5bar @ 180°C
	70bar at -10 to +40°C

Materials of Construction

Body	ASTMA351-CF8M
End cap	ASTMA351-CFM8
Seat	PTFE
Gasket	PTFE
Ball	ASTM A351-CF8M/316
Thrust washer	PTFE
Stem	ASTM A276-316
Stem packing	PTFE
Gland	AISI304
Handle	AISI304
Handle washer	AISI304
Handle nut	AISI304
Handle cover	PVC